

MultiBio700

Multi-biometric Access Control and Time & Attendance Terminal



MultiBio 700 is a new generation multiple biometric identification product. Integrating with Face, Fingerprint and PIN recognition and optional with RFID mode. It performs up to 20 verification methods all in a single device conveniently.

MultiBio700 stores 1500 faces and 2000 fingerprint templates and identifies users by 1:N mode. When users glance into the MutiBio700 camera, it captures the relative position, size, and shape of user's eyes, nose, cheekbones, and jaw features. These parameters are used to create a biometric template which is then used to subsequently verify or identify each user.

MultiBio700 can be used as a standalone access control reader by connecting a door lock, exit switch, alarm and door sensor to the relay contacts. The Wiegand IN and OUT ports can be used to connect 3rd party access control panels and peripherals. The MultiBio700 also includes a USB port for offline data backup/management.



Fast and Accurate Fingerprint and Facial Identification Algorithm

- 1 stand or 1 touch a second user recognition
- Stores 1500 faces and 2000 fingerprint templates



Multiple Verification Modes

- 20 verification modes are available to improve security level. Default verification modes are Fingerprint only, Face only or RFID only. Other 19 modes are available.



Easy Installation and Connectivity

- Wiegand input & output
- Network interface by TCP/IP or RS485



Full Access Control Features

- Anti-passback
- Access control interface for 3rd party electric lock, door sensor, exit button, alarm and doorbell



Good Performance in Dark Environment

- Infra-red optical system enables machine to work well at night.

Specifications

Display	3-inch Touch Screen
Face Capacity	1,500 (1:1N)
Fingerprint Capacity	2,000
ID Card Capacity(optional)	10,000
Log Capacity	100,000
Camera	High Resolution Infrared Camera
Sensor	ZK Optical Sensor
Communication	TCP/IP, RS232/485, USB-host
Access Control Interface for	3rd party electric lock, door sensor, exit button, alarm, wired doorbell
Anti-pass back Function	Yes
Wiegand Signal	Input & Output
Standard Access Control Function	Time Zone, Group, Multi-identification Duress mode, Anti-passback, Tamper alarm
Optional Functions	ID Card, Mifare Card
Power Supply	12V DC
Operating Temperature	0 - 45 °C
Operating Humidity	20% -80%
Dimension(LxHxD)mm	209.4×87.5×91.6
Gross Weight	0.87kg

Optional Accessories



RFID Reader



Exit Button



Electric Lock



Alarm



Sensor

Configuration

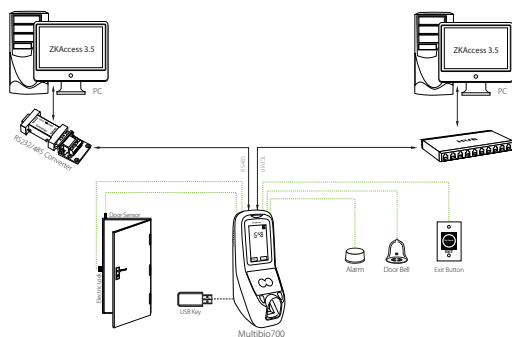

Dimensions (mm)

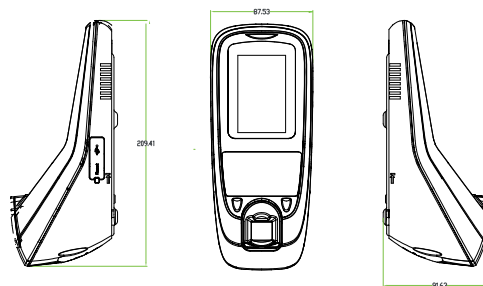

ZKTeco Inc.

ZK Mansion, Wuhe Rd, Gangtuo, Bantian, Buji Town,
Longgang District, Shenzhen China 518129
Tel: 86-755-8960 2345/46/47/48
E-mail: sales@zkteco.com
www.zkteco.com

Global Offices:

USA: +1 732-412-6007
EU: +34 916532891
Brazil: +55 31 2515-8326
Thailand: +66-027199154
Mexico: +52-55-52928418

South Africa: +27 12 259 1047
Egypt: +201110444134
Dubai: +971 4 6091 310
India: +91 8123536788
Indonesia: +62 21 2921 8949

Vietnam: +84-0169-5813007
Philippines: +63 9084118832
Russia: +8 915 178-46-81