

FMB Series Mounting Bracket



FMB-01



FMB-02
0.6M



FMB-03
0.8M



FMB-04
1.1M

The FMB series of mounting brackets (FMB-01/FMB02/FMB03/FMB04) is suitable for indoor and semi-outdoor scenarios and users of different heights. The bracket is made of refined SPCC steel and coated with modern baking varnish, enabling excellent corrosion resistance. It can provide customers with better user experience.

Features

- High compatibility with different models
- With LED strip, classic and minimalist design

Specifications

FMB-01	FMB-02	FMB-03	FMB-04
321*288*57.5mm	321*288*612mm	321*288*832mm	321*288*1112mm
2KG	5.2KG	6.5KG	7.9KG

Compatible models: Proaface X [CH], Proaface X[CH/P], Proaface X [CH/TD], Elite Pass, Proface XE [CH], FaceDepot-7B/7BL [CH]

KJZ-03: KJZ-03 & SpeedFace-V5L Series, KJZ-03 & SpeedFace-H5L Series

Application Situation: Indoor or semi-outdoor environments

Dimensions (mm)

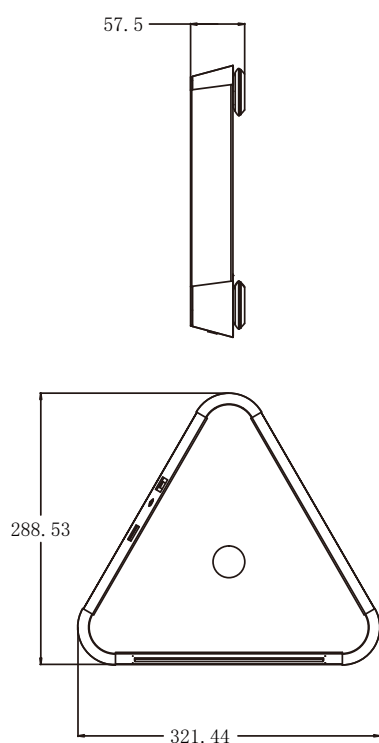

FMB-01



FMB-02



FMB-03

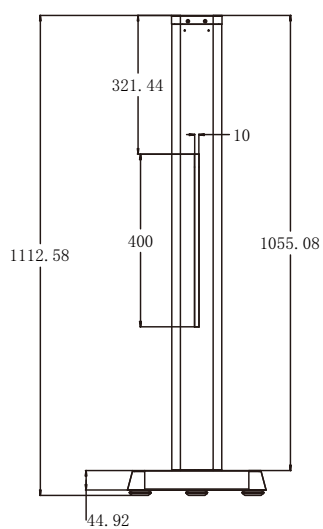
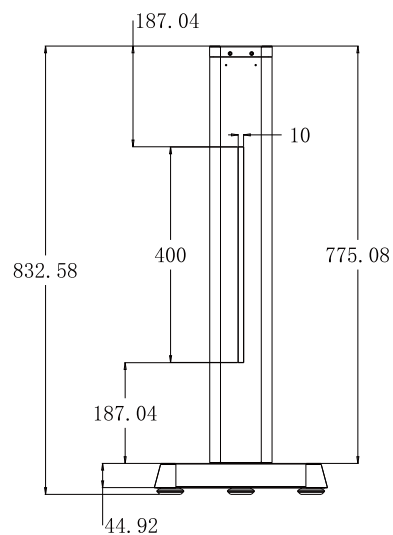
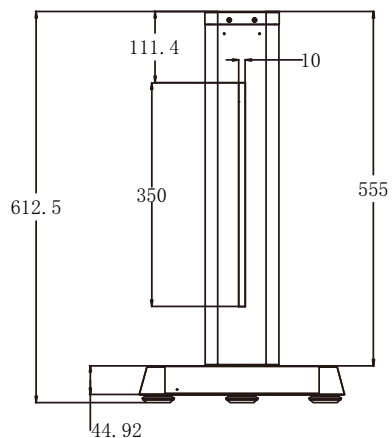

FMB-04

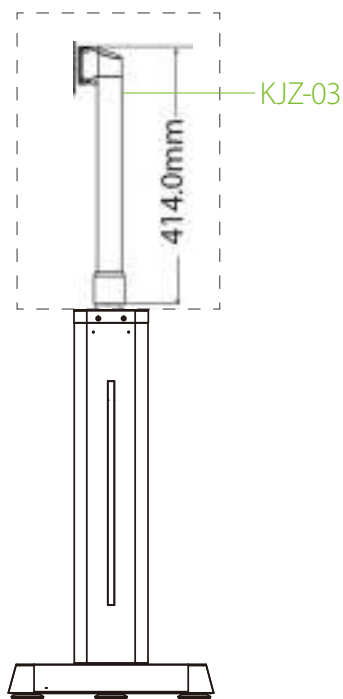

FMB-01 / 02 / 03 / 04

