

TDN WDR IR Mini Dome Camera

H4W4PRV3

Honeywell's rugged H4W4PRV3 mini dome camera is taking quality and reliability to the next level, offering outstanding picture clarity and hassle-free flexible system integration.

Superior Image Quality

- Full HD 4 MP 20 fps image with a 1/3" 4 megapixel sensor
- Wide Dynamic Range, up to 120 dB, ensures glare-free images
- True Day/Night provides vivid color images by day and clear black-and-white images at night with ICR
- Excellent low-light performance with 3D noise reduction, saving storage and bandwidth

Flexible Surveillance Solution

- 2.8 mm fixed lens at F2.0
- H.264 and MJPEG codec, triple stream support
- IR LEDs provide up to 98 ft (30 m) of illumination in dimly lit or nighttime scenes (depending on scene reflectance)
- Smart IR technology provides even distribution of IR
- Weatherproof (IP66) and vandal-resistant (IK10) camera housing
- -30°C to 60°C (-22°F to 140°F) working temperature
- Plug-and-play compatible with Honeywell 4/8/16-channel Performance Series Embedded NVRs

Easy to Install and Use

- Built-in PoE (Power over Ethernet) eliminates need for separate power supply and associated wiring; 12 VDC inputs where PoE power is unavailable
- Remote configuration through web client or from the NVR
- Compatible with HQA-BB2 junction box, HQA-WK wall mount, HQA-PM pole mount, and HB34S2-CM corner mount



Market Opportunities

These flexible, fully featured cameras are ideal for a wide range of surveillance applications, providing excellent picture quality at minimal bandwidth while offering reliable protection against dust, dirt, and water.

FEATURES AND BENEFITS

- | | | | |
|-------------------------------------|---|-----------------------------------|--|
| • 1/3" 4 MP progressive scan imager | • Low-light performance down to 0.01 lux (color) or 0 lux with IR LEDs on | • Triple stream support | • Plug-and-play compatible with Honeywell Performance Series Embedded NVRs |
| • 2.8 mm fixed lens | • Up to 100 ft (30 m) IR illumination, depending on scene reflectance | • Up to 4 MP resolution at 20 fps | • IP66 and IK10-rated rugged housing |
| • True day/night (IR-cut filter) | • H.264 Main Profile compression | • Supports up to 20 connections | |
| • Wide dynamic range up to 120 dB | | • Corridor mode | |
| | | • PoE, 12 VDC support | |

TDN WDR IR Mini Dome Camera

Security Features

The camera can be configured to automatically detect and respond to events such as motion in the scene and/or camera tampering. Automated responses include sending a notification through email, FTP, and/or HTTP, and sending a still image of the event through email and/or FTP. Setup can be done using the web client or from an NVR.

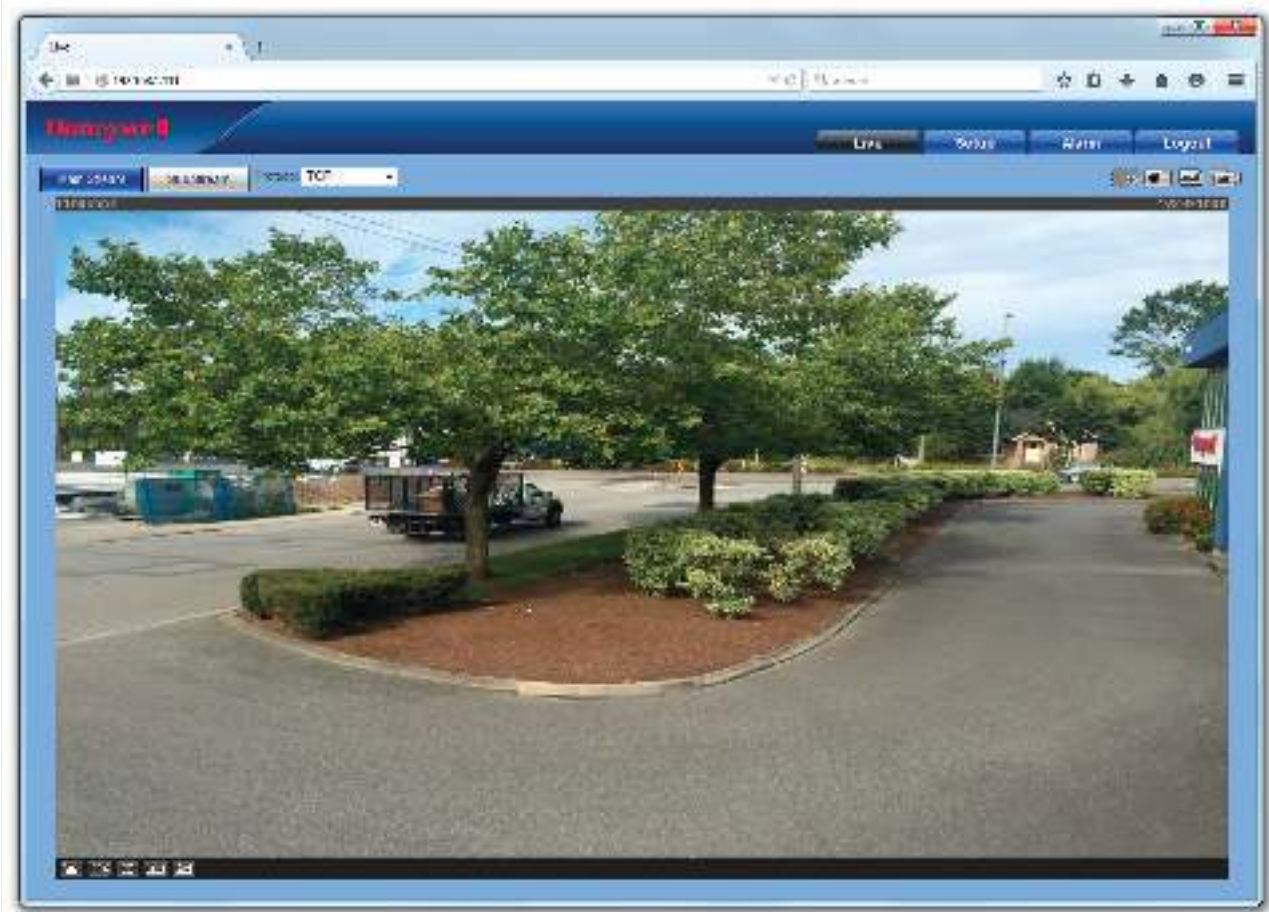

DIMENSIONS

H4W4PRV3

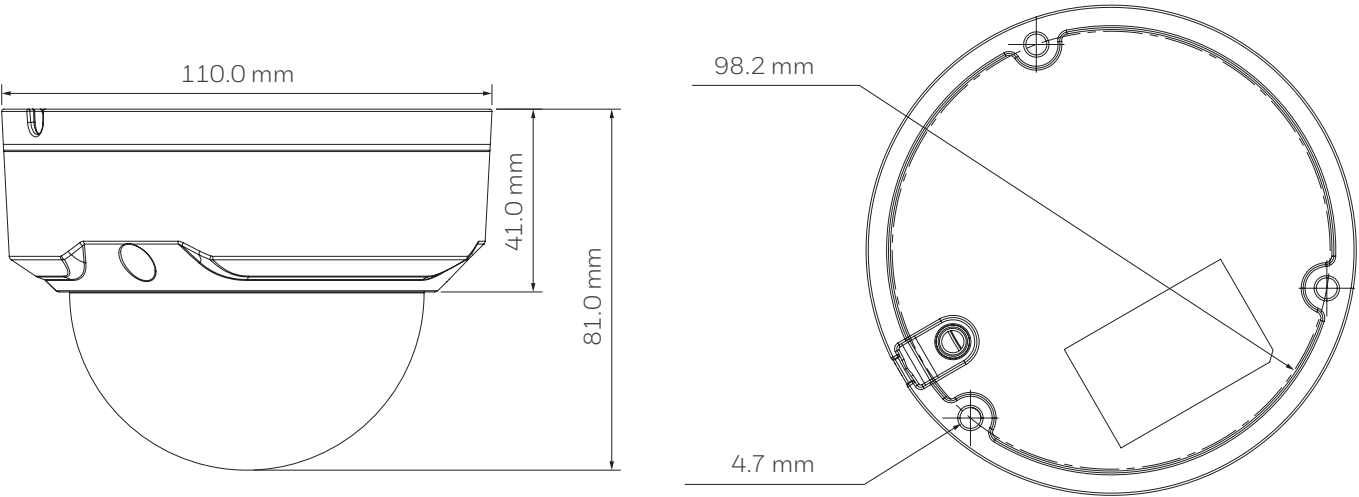

TDN WDR IR Mini Dome Camera

SPECIFICATIONS

OPERATIONAL		
VIDEO STANDARD		NTSC/PAL
SCANNING SYSTEM		Progressive scan
IMAGE SENSOR		1/3" 4 MP CMOS
NUMBER OF PIXELS (H×V)		2688×1520
MINIMUM ILLUMINATION		0.01 lux, F2.0 (color) 0 lux (with IR LEDs on)
S/N RATIO		50 dB or more
ELECTRONIC SHUTTER SPEED		Auto, Manual, 1/3–1/100 000 s
IR DISTANCE		Up to 98 ft (30 m), depending on scene reflectance
DAY/NIGHT		Auto(ICR)/Color/BW
BACKLIGHT COMPENSATION		BLC/HLC/WDR (120 dB)
WHITE BALANCE		Auto/Sunny/Night/Outdoor/ Customized
GAIN CONTROL		Auto/Manual
NOISE REDUCTION		3DNR
PRIVACY MASKING		Up to 4 areas
LENS		2.8 mm, F2.0
HORIZONTAL ANGLE OF VIEW		106°
CORRIDOR MODE		Yes
VIDEO		
VIDEO COMPRESSION		H.264/H.264H/H.264B/MJPEG
RESOLUTION		4 MP (2688×1520/2560×1440)/ 3 MP (2304×1296)/1080p (1920×1080)/720p (1280× 720)/D1(704×576/704×480)/ CIF(352×288/352×240)
FRAME RATE	MAIN STREAM	4 MP (1–20 fps)/ 3MP (1–25/30 fps)
	SUB STREAM	D1/CIF (1–25/30 fps)
	TRIPLE STREAM	720p (1–20 fps)
BIT RATE (H.264)		32 Kbps–10 Mbps

NETWORK	
ETHERNET	RJ-45 (10/100Base-T)
PROTOCOLS*	IPv4/IPv6, HTTP, HTTPS, SSL, TCP/ IP, UDP, UPnP, ICMP, IGMP, SNMP, RTSP, RTP, SMTP, NTP, DHCP, DNS, PPPoE, DDNS, FTP, IP Filter, QoS, Bonjour, 802.1X
COMPATIBILITY	ONVIF Profile S
MAX. USER ACCESS	20 users
MOBILE DEVICES	iPhone, iPad, Android
ELECTRICAL	
POWER SUPPLY	PoE (802.3af), 12 VDC
POWER CONSUMPTION	4.0 W max.
MECHANICAL	
DIMENSIONS	110.0 × 81.0 mm (4.33 × 3.19 in.)
PRODUCT WEIGHT	0.73 lb (0.33 kg)
PACKAGE WEIGHT	1.04 lb (0.47 kg)
CONSTRUCTION	Die-cast aluminum housing with powder coat
CONSTRUCTION COLOR	RAL 9003 (White)
ENVIRONMENTAL	
TEMPERATURE	–30°C to 60°C (–22°F to 140°F)
RELATIVE HUMIDITY	0–95%, non-condensing
INGRESS PROTECTION	IP66
VANDAL RESISTANCE	IK10
REGULATORY	
EMISSIONS	FCC Part 15, CE (EN 55032)
IMMUNITY	CE (EN 50130-4)
SAFETY	North America UL Listed to UL/CSA 60950-1, CE (EN 60950-1) North America UL Listed to UL/CSA 60950-22, CE (EN 60950-22)

** Some development
may be required in
specific user cases
to support some
of these protocols
in the field as they
mature over time.*

TDN WDR IR Mini Dome Camera

SPECIFICATIONS

SYSTEM INTEGRATION

OPEN IP INTEGRATION

ONVIF support and open API software integration. Refer to www.onvif.org for the ONVIF specification and the Honeywell Open Technology Alliance website (<http://www.security.honeywell.com/hota/>) to learn more about our open and integrated solutions.



ORDERING

ACCESSORIES

MOUNTS

HQA-BB2	Junction box
HQA-WK	Wall mount
HQA-PM	Pole mount (requires HQA-BB2)
HB34S2-CM	Corner mount (requires HQA-BB2)

CAMERAS

H4W4PRV3	Network TDN WDR IR Mini Dome Camera, 1/3" CMOS, 4 MP, 2.8 mm Fixed, 24 IR LEDs, PoE, H.264
----------	--

For more information

www.honeywell.com/security/uk

Honeywell Security and Fire

Aston Fields Road
Whitehouse Industrial Estate
Runcorn
Cheshire
WA7 3DL
UK
Tel: 08448 000 235
Fax: +44 (0)1928 754 050
www.honeywell.com

Honeywell reserves the right, without notification, to make changes in product design or specifications.

HSFV-PerfR2-MiniDome-01-UK(0117)DS-E
January 2017
© 2017 Honeywell International Inc.

Honeywell