

QUICK START GUIDE

Applicable Model: G2



ZK Building, Wuhe Road, Gangtou, Bantian, Buji Town,
Longgang District, Shenzhen China 518129
Tel:+86 755-89602345
Fax:+86 755-89602394
www.zkteco.com



© Copyright 2015, ZKTECO Inc. ZKTECO Logo is a registered trademark of ZKTECO or a related company. All other product and company names mentioned are used for identification purposes only and may be the trademarks of their respective owners. All specifications are subject to change without notice. All rights reserved.

Safety Precautions

Before installation, please read the following safety precautions for user safety and to prevent device damage.

- Do not install the device in a place subject to direct sun light, humidity, dust or soot.
- Do not place magnet near the product. Magnetic objects such as magnet, CRT, TV, monitor or speaker may damage the device.
- Do not place the device next to heating equipment.
- Do not let liquid like water, drinks or chemicals leak inside the device.
- Do not let children touch the device without supervision.
- Do not drop or damage the device.
- Do not disassemble, repair or alter the device.
- Do not use the device for any purpose other than those specified.
- Clean the device often to remove dust on it. While cleaning, do not splash water on the device but wipe it out with smooth cloth or towel.

Contact your supplier in case of any problem!

Device Overview

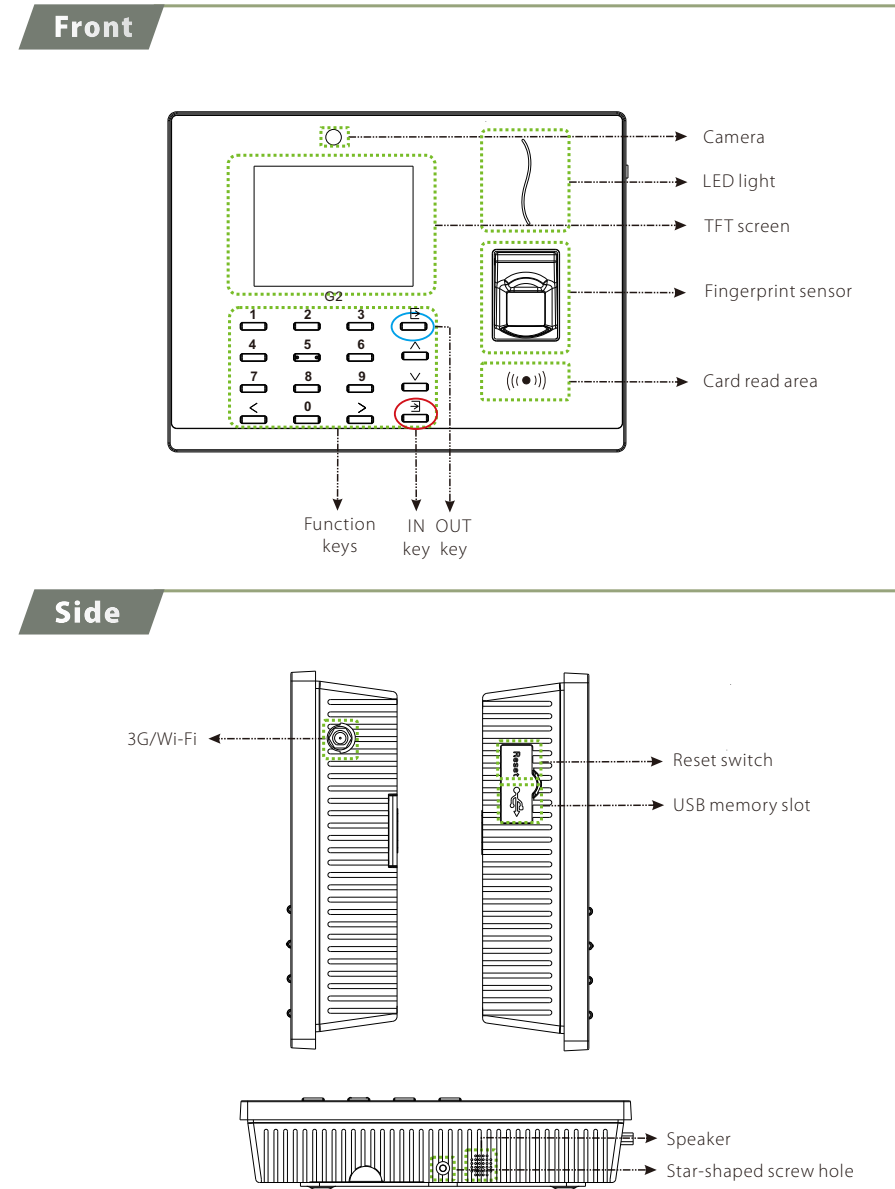

Product PIN Diagram

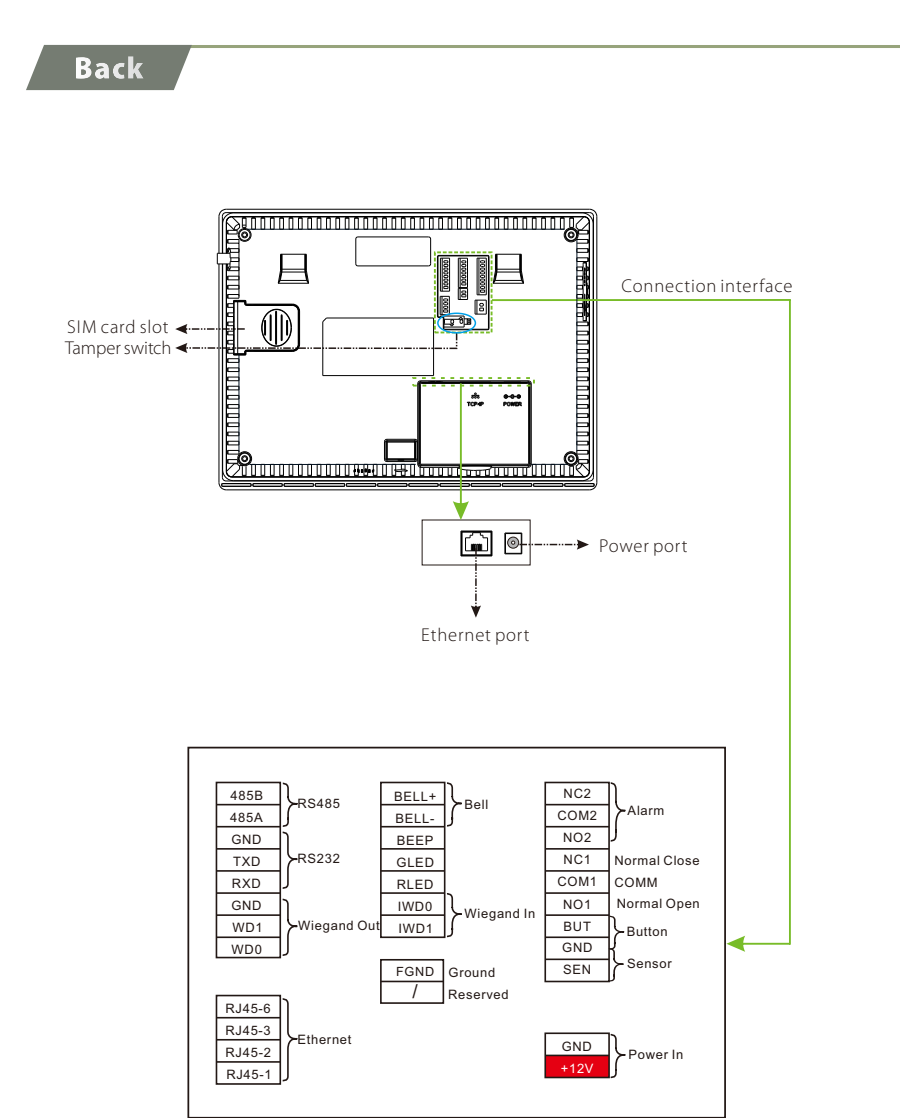

Product Dimension & Installation

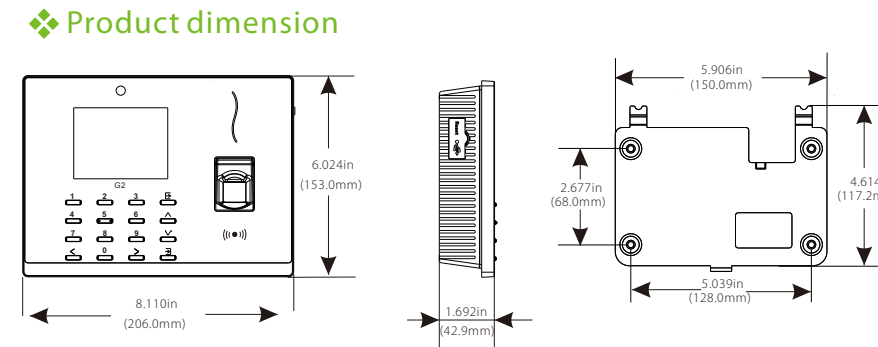

Mounting the device on wall

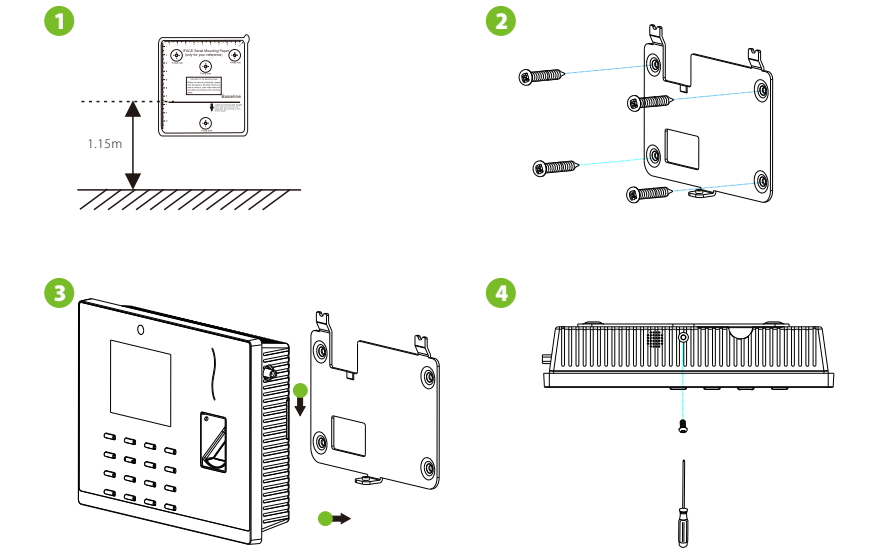

- Paste the mounting template sticker onto the wall, and drill holes according to the mounting paper.
- Fix the back plate onto the wall using wall mounting screws.
- Insert the device into back plate.
- Use security screw to fasten the device to back plate.

Bell & Wiegand Connection

External bell connection

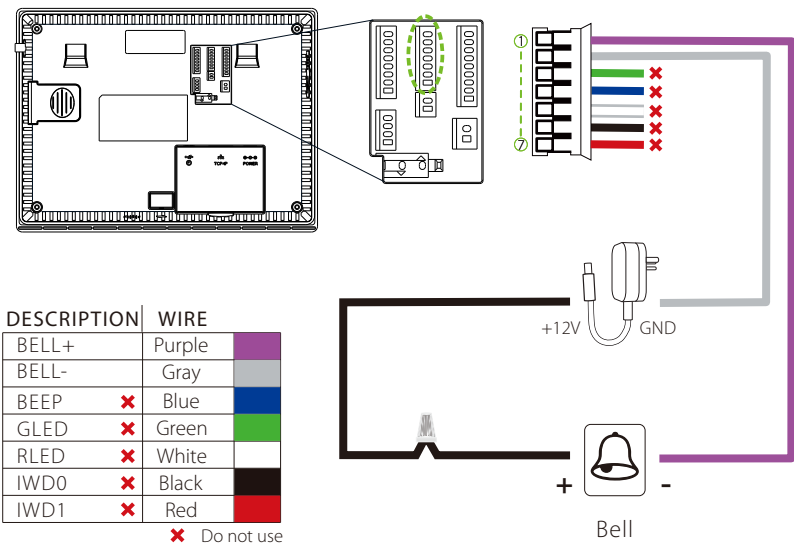

Wiegand In connection

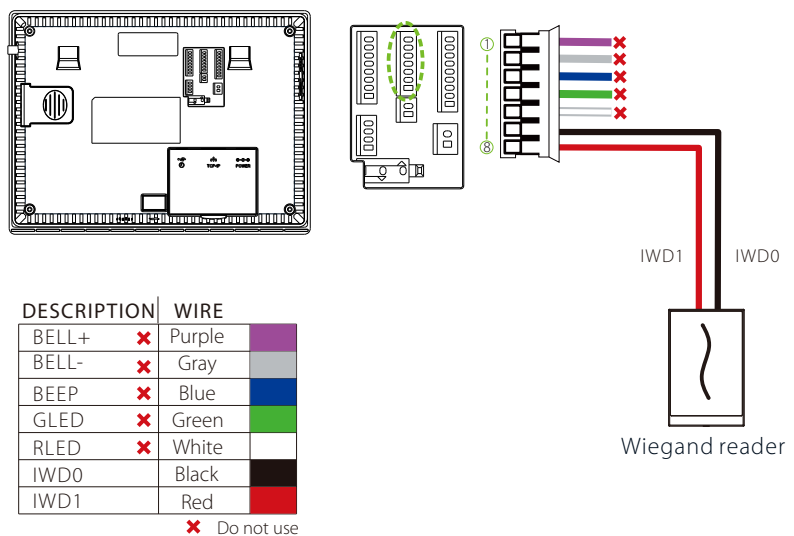

Lock Relay Connection

The system supports Normally Open Lock and Normally Closed Lock. For example the NO LOCK (normally) opened.

Device not sharing power with the lock

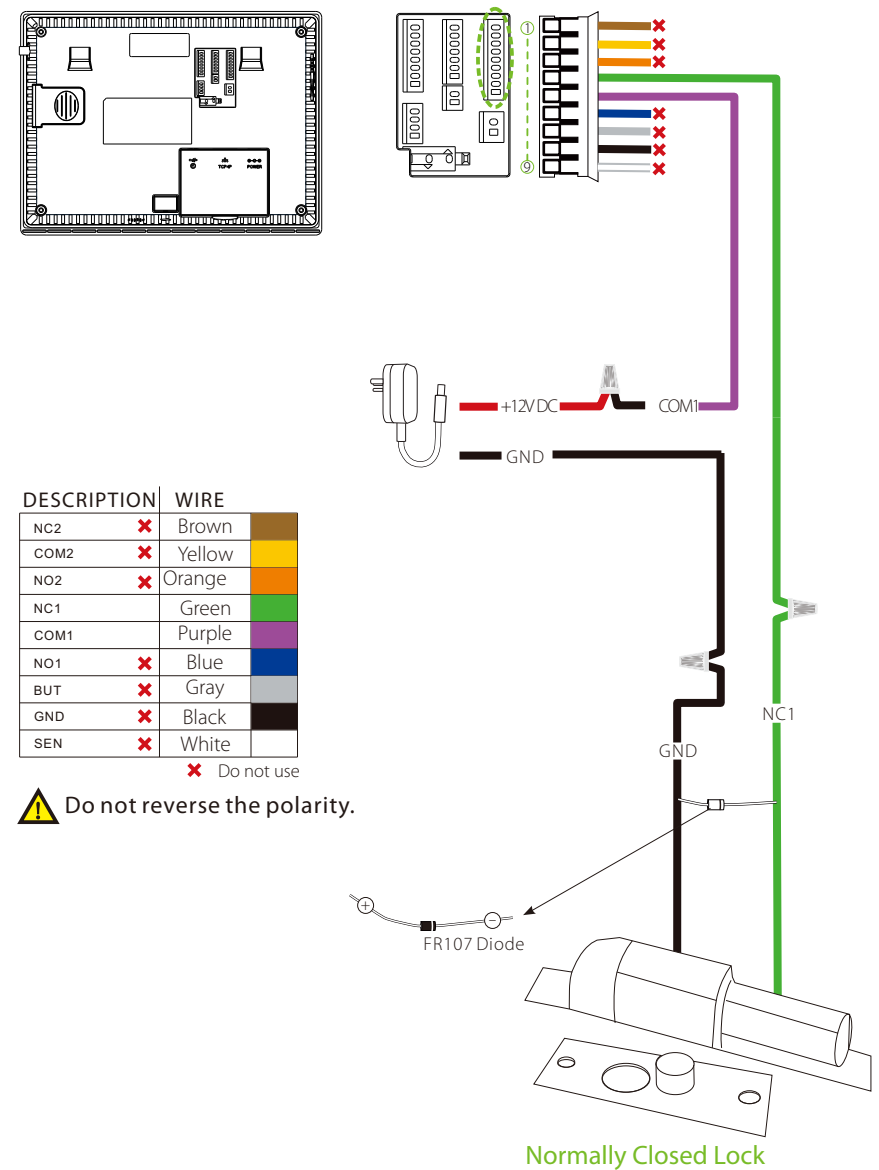

Lock Relay Connection

Device sharing power with the lock

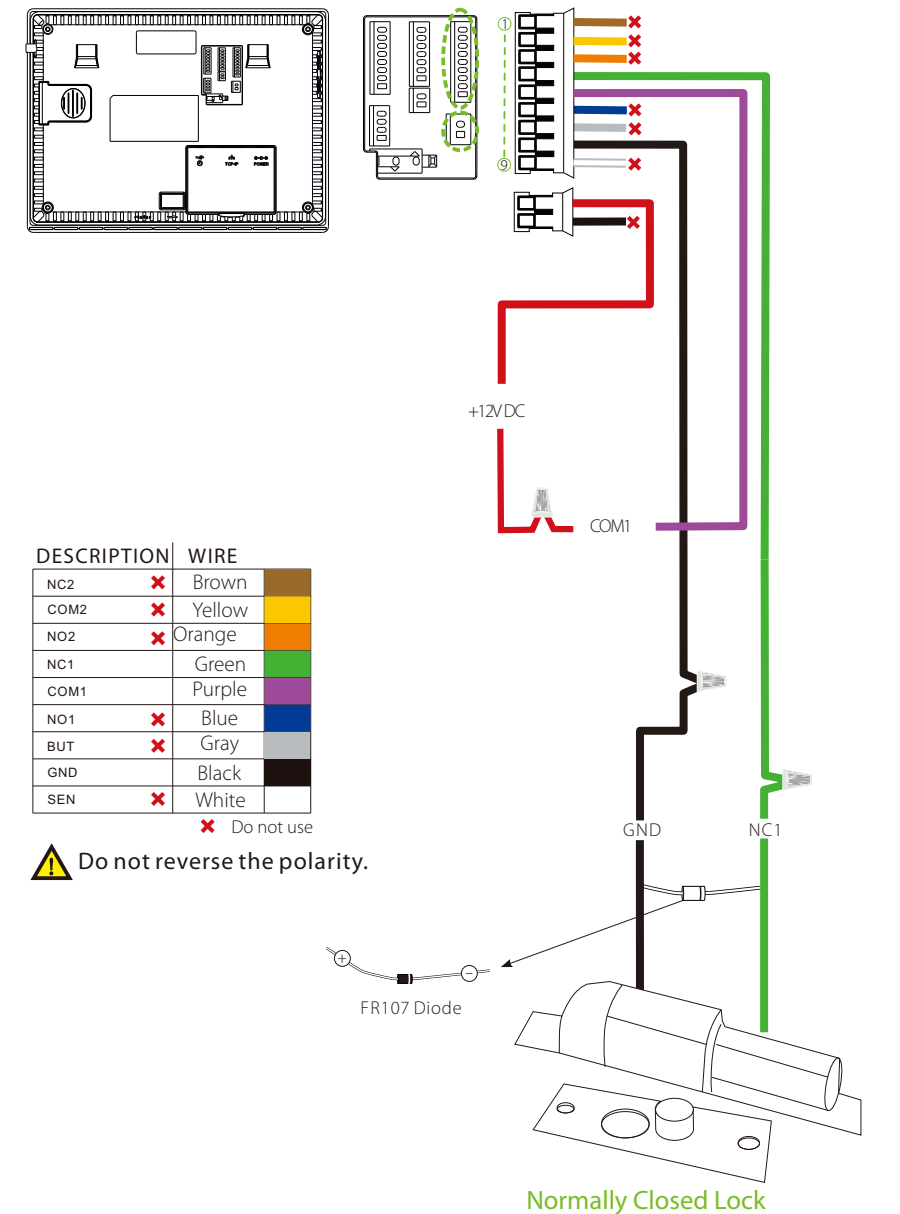

Ethernet Connection

LAN connection

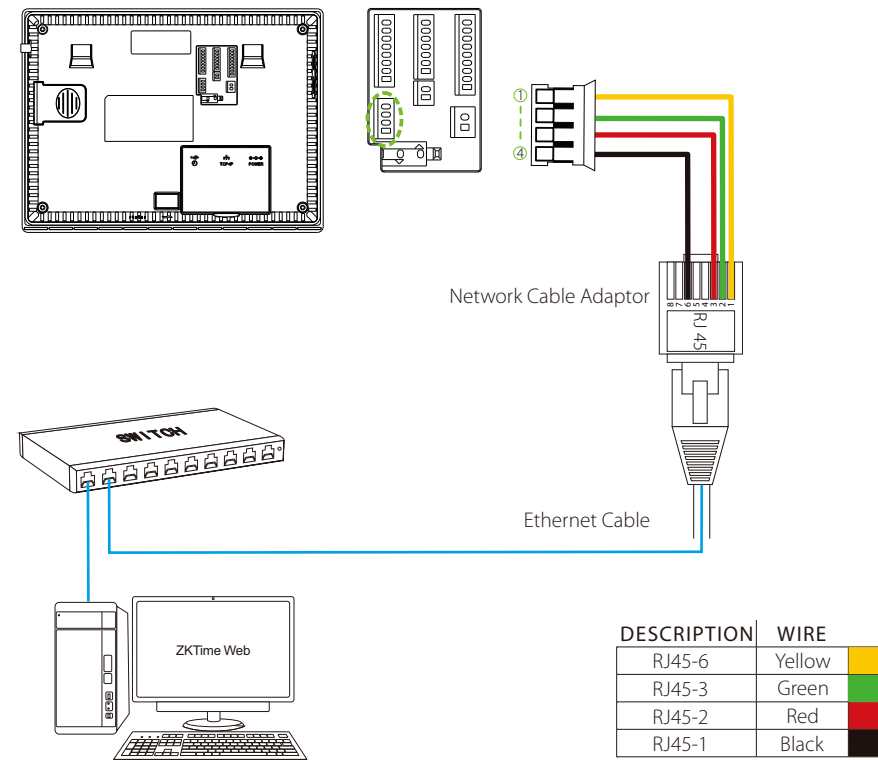

Another way for ethernet connection

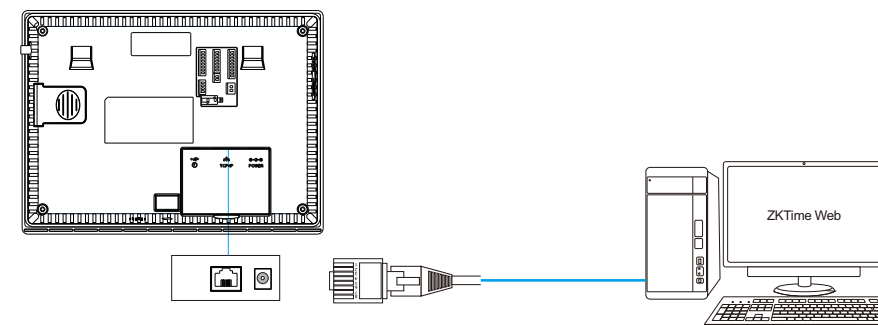

Note: The device can be connected to PC directly by ethernet cable.

Wiegand Output Connection

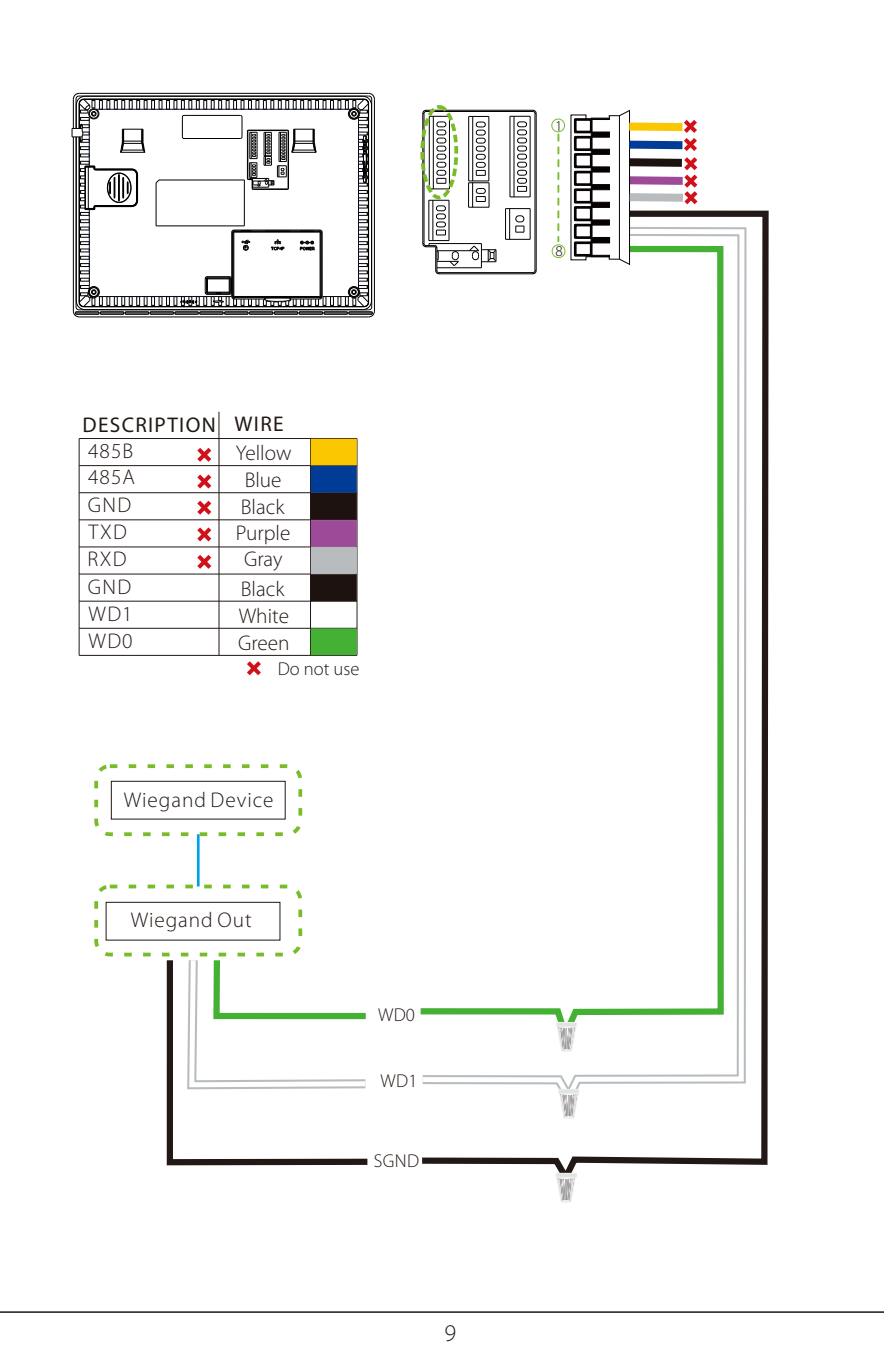

9

RS232 Connection

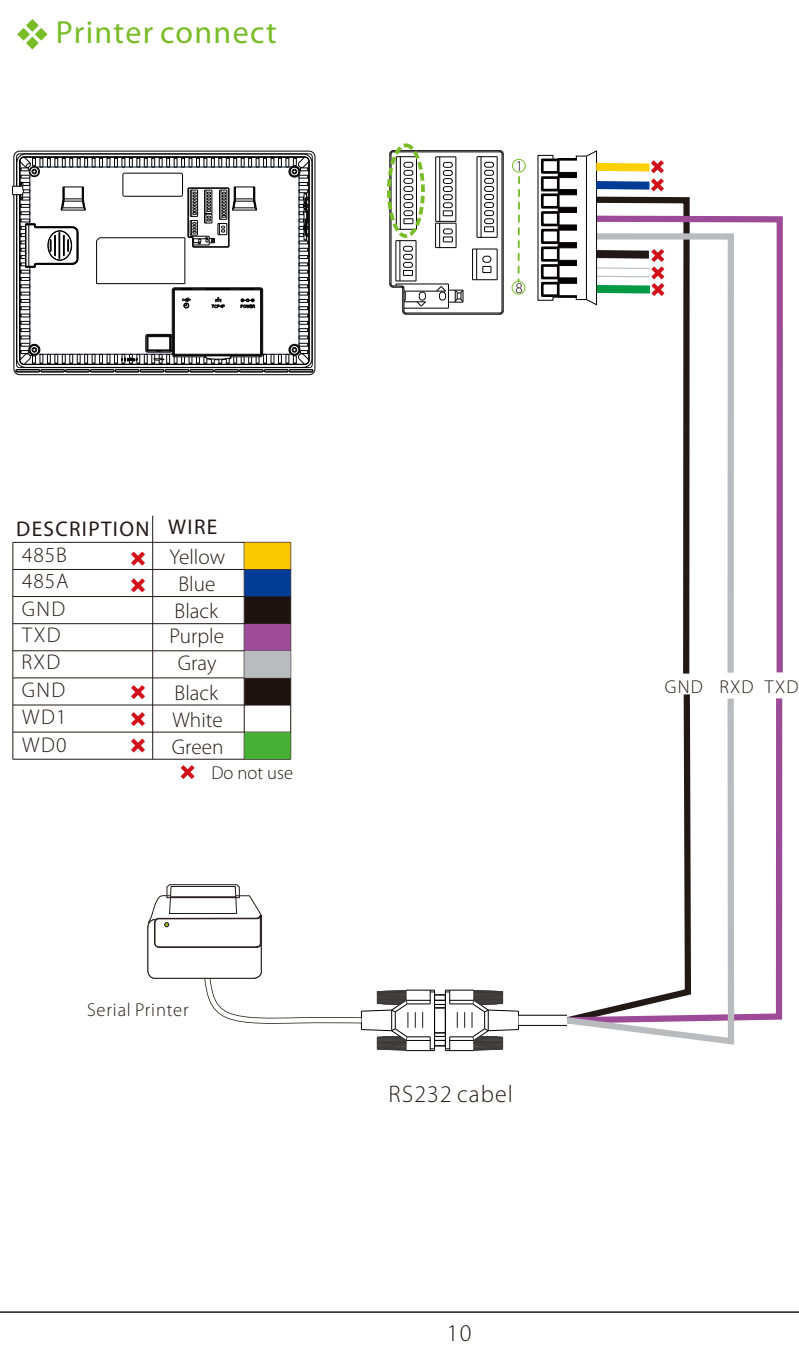

10

Alarm Connection

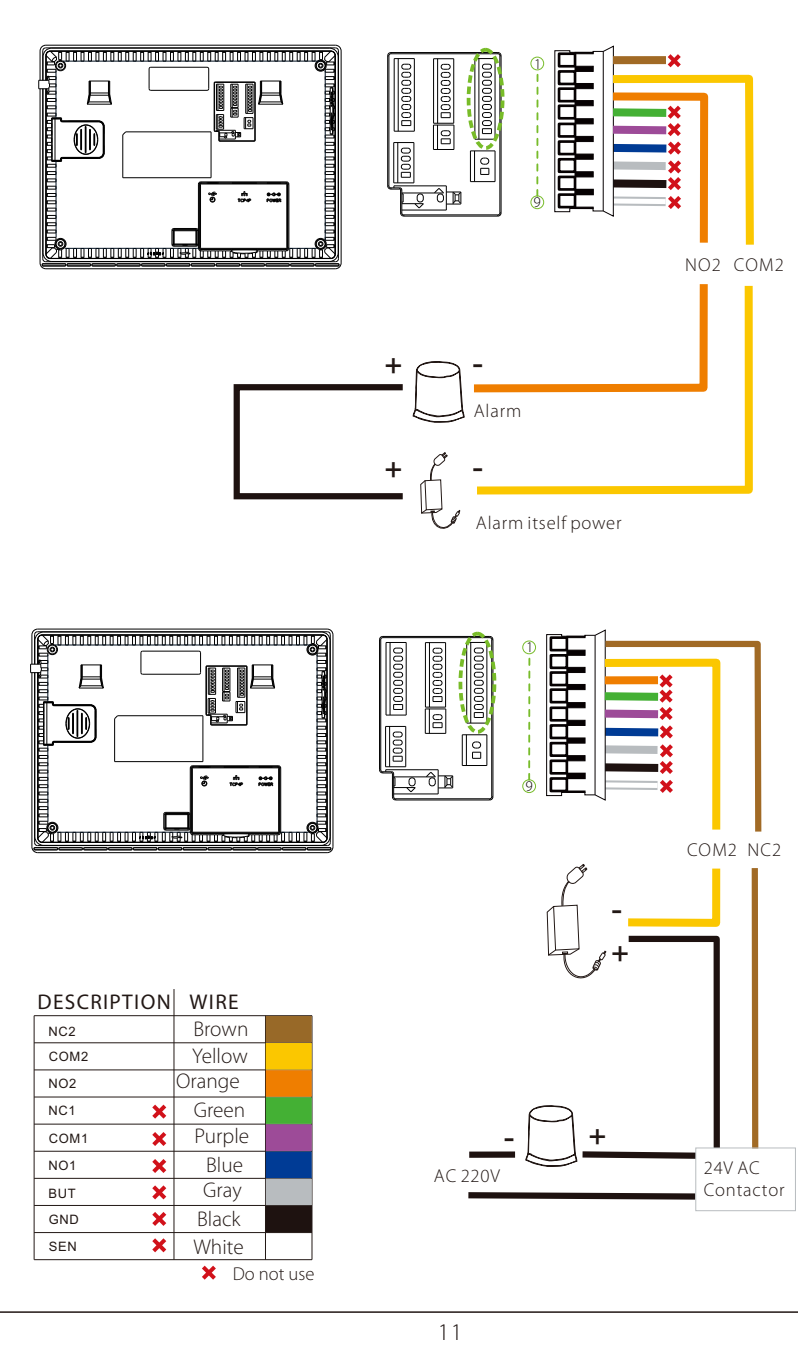

11

Button & Sensor Connection

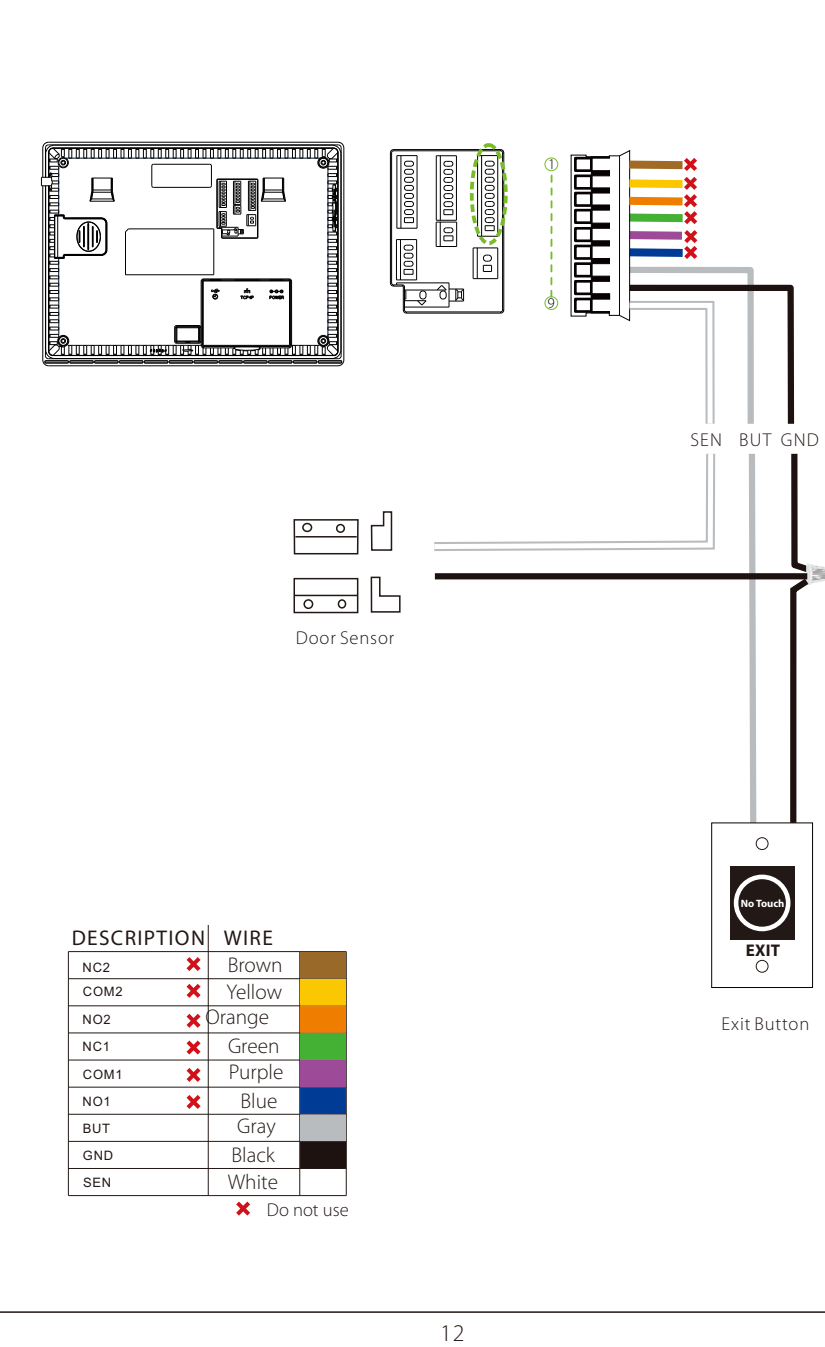

12

Power Connection

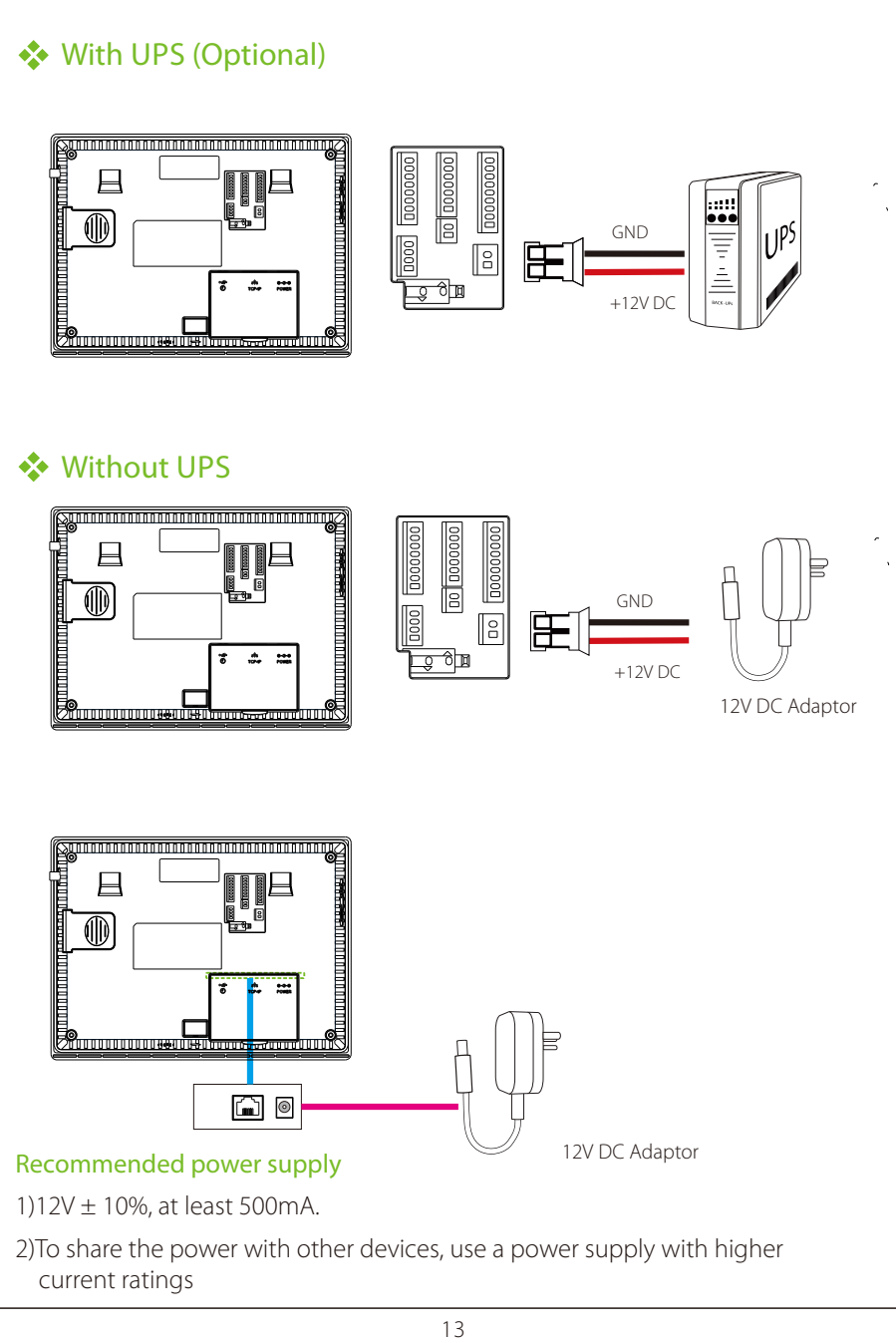

13

Standalone Installation

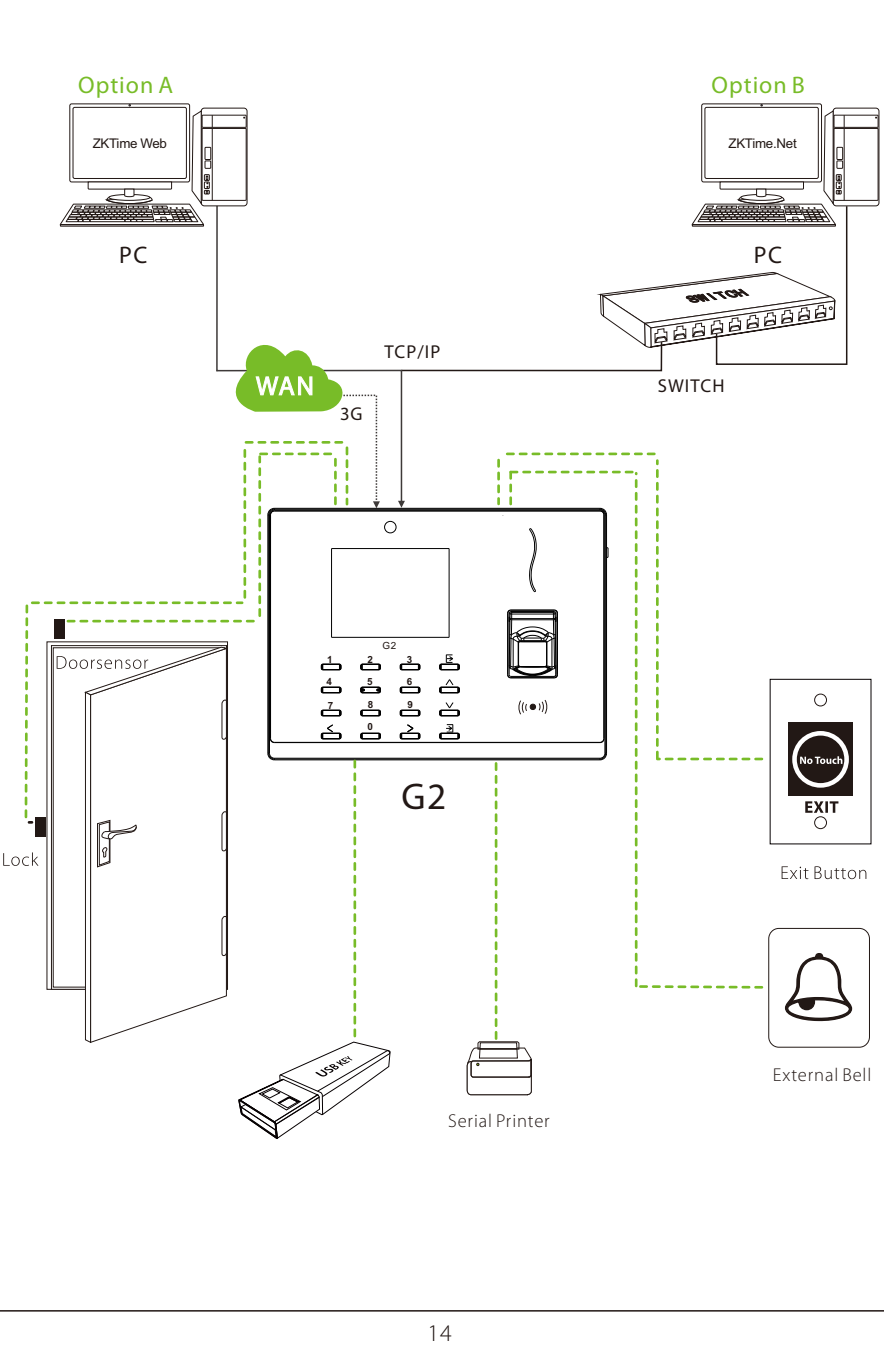

14

Device Operation

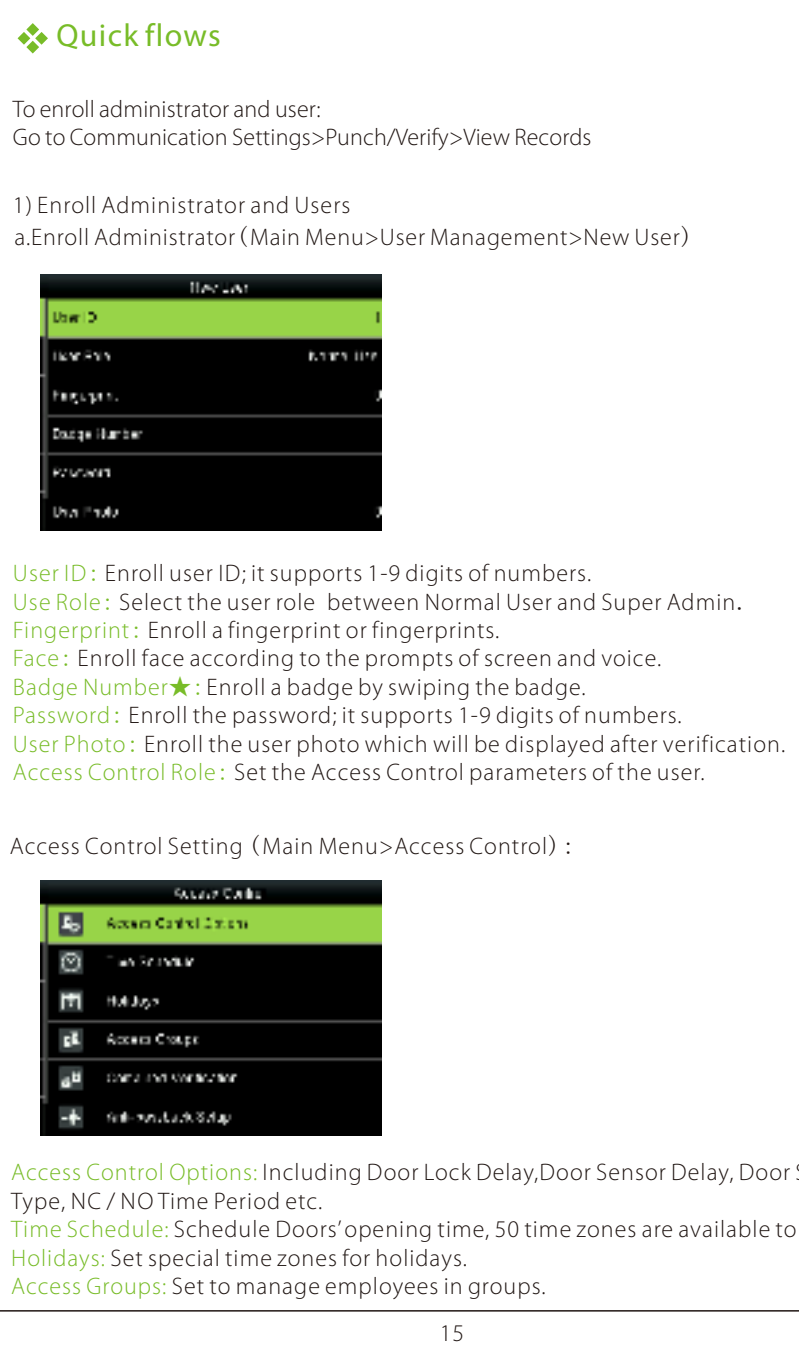

15

Device Operation



16

Device Operation

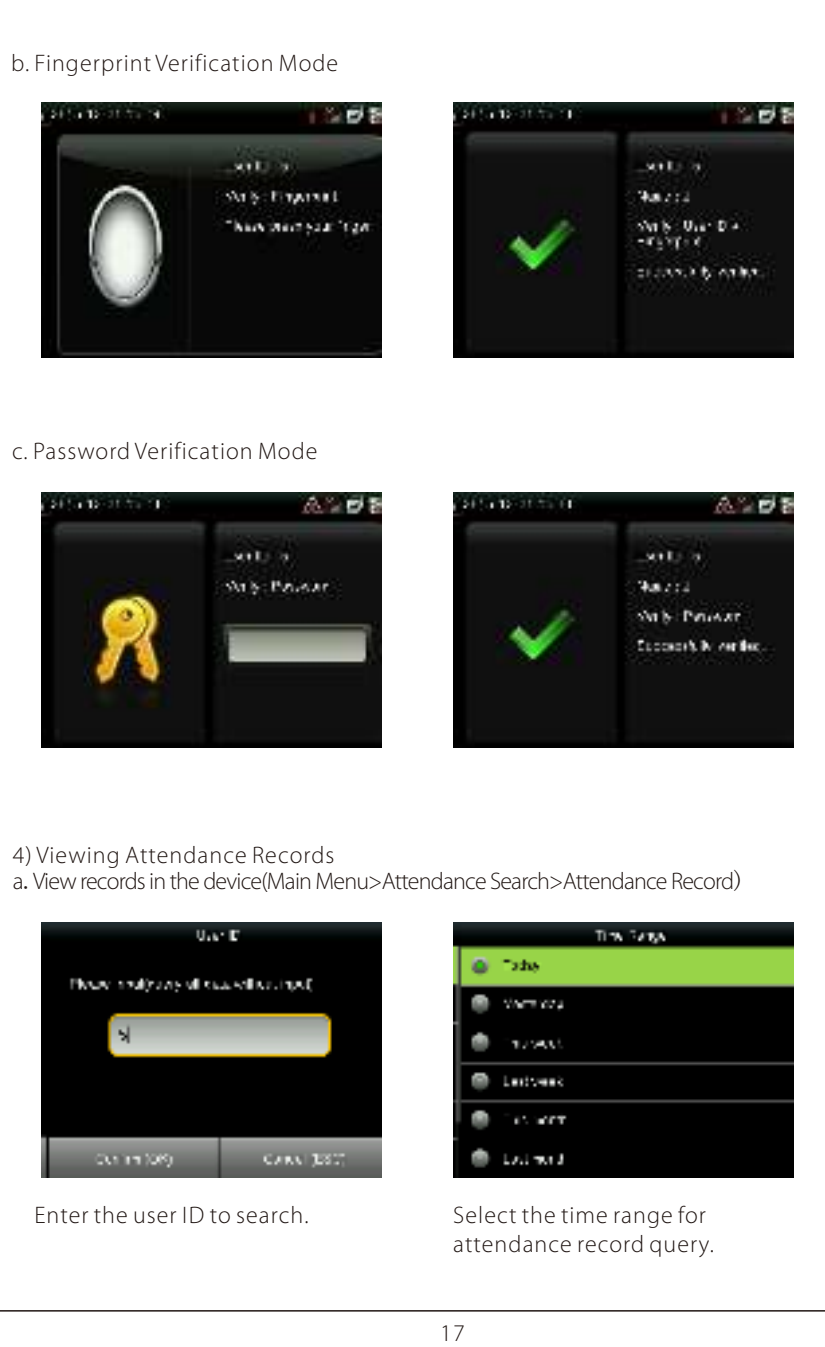

17

Device Operation

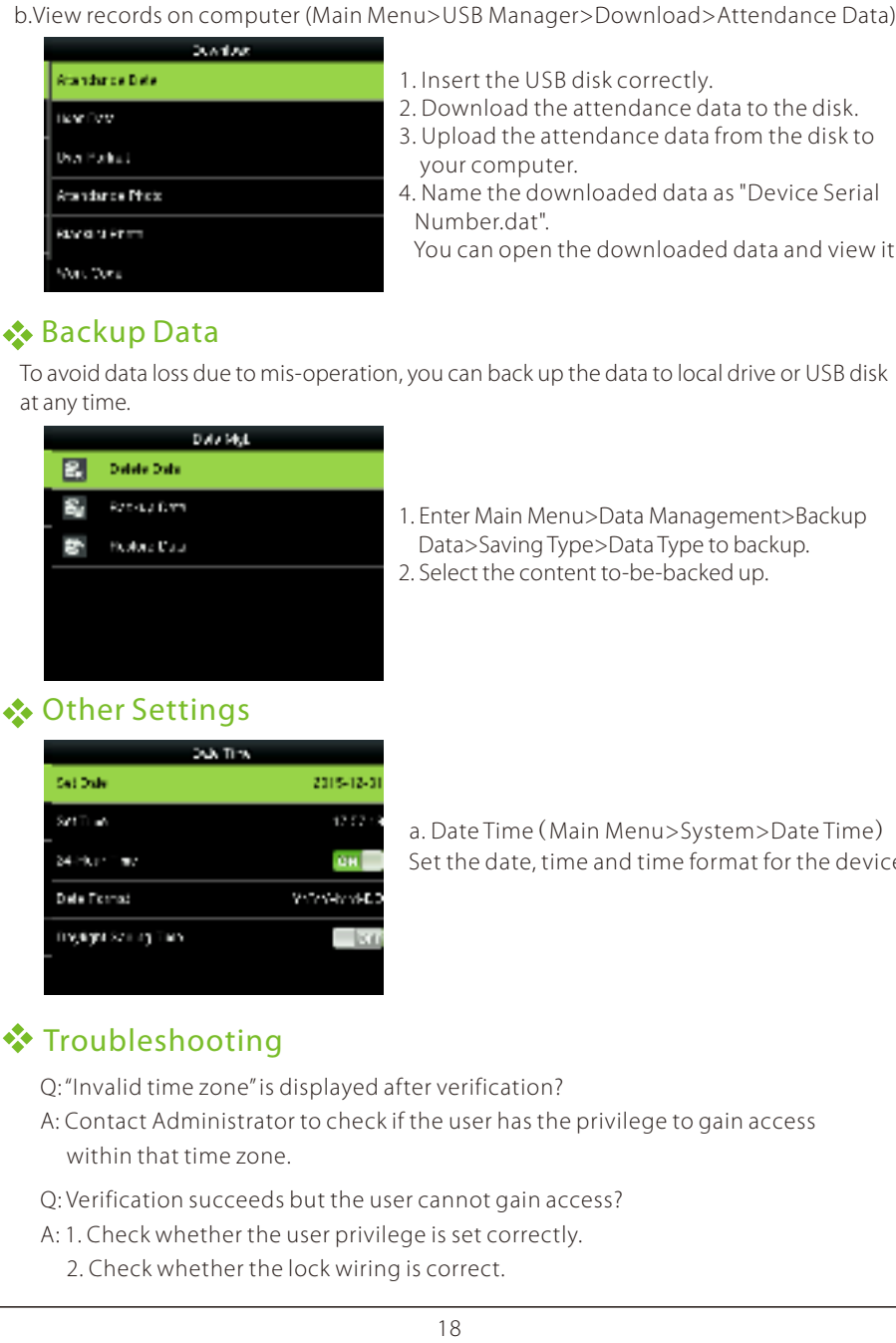

18